

Short Title

BIG SHANTY ROAD WIDENING PHASE IV FROM
CHASTAIN MEADOWS PARKWAY TO BELLS FERRY ROAD

GDOT Project No.

N/A

Federal ID No.

N/A

Status

Long Range

Service Type

Roadway / General Purpose Capacity

Sponsor

Cobb County

Jurisdiction

Cobb County

Analysis Level

In the Region's Air Quality Conformity Analysis

Existing Thru Lane

2

Planned Thru Lane

4

Detailed Description and Justification

This project involves adding one general purpose lane in each direction along Big Shanty Road between Chastain Meadows Parkway and Bells Ferry Road.

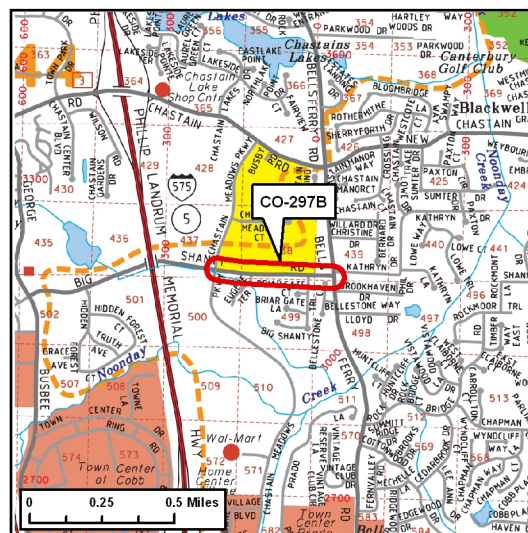

Copyright 2005 Aero Surveys of Georgia, Inc. Reproduced by permission of the copyright owner. Contact <http://www.aerotas.com>

Network Year

2030

Corridor Length

0.4 miles

Phase Status & Funding Information		Status	FISCAL YEAR	TOTAL PHASE COST	BREAKDOWN OF TOTAL PHASE COST BY FUNDING SOURCE			
					FEDERAL	STATE	BONDS	LOCAL/PRIVATE
ALL	Local Jurisdiction/Municipality Funds		LR 2018-2030	\$8,400,000	\$0,000	\$0,000	\$0,000	\$8,400,000
				\$8,400,000	\$0,000	\$0,000	\$0,000	\$8,400,000

SCP: Scoping PE: Preliminary engineering / engineering / design / planning PE-OV: GDOT oversight services for engineering ROW: Right-of-way Acquisition
 UTL: Utility relocation CST: Construction / Implementation ALL: Total estimated cost, inclusive of all phases



For additional information about this project, please call (404) 463-3100 or email transportation@atlantaregional.com.

